

**PROCESS MEASUREMENT
&
CONTROL SPECIALISTS**



TamiLok

**Instrumentation Valves,
Fittings and
Accessories**



PALM TREE ENGINEERING PRODUCTS PRIVATE LIMITED

Plot no 110, SIDCO Industrial Estate, Vallioor, Tirunelveli, Tamilnadu, India. 627117

contact@palmtreeind.com

www.palmtreeind.com

TUBE FITTINGS SELECTION CHART

T	MC	M	04	38	N	SS	OPTION
---	----	---	----	----	---	----	--------

T = TAMILOK

I = Imperial Range
M = Metric Range

MC=Male Connector,
FC=Female Connector
EU = Equal Union,
UU = Unequal Union
BMC=Bulkhead Male Connector
BFC = Bulkhead Female Connector
C = Cap, P = Plug
BU = Bulkhead Union,
UE = Union Elbow,
ME = Male Elbow,
FE = Female Elbow
UC = Equal Union Cross,
UT = Union Tee
MBT=Male Branch Tee,
FBT= Female Branch Tee
MRT = Male Run Tee,
FRT = Female Run Tee
N = Nut, F = Ferrule
FTA = Female Tube Adaptor
MTA = Male Tube Adaptor
WC = Weld Connector,
VP = Vent Plug

14 = 1/4"
38 = 3/8"
12 = 1/2"
34 = 3/4"
01 = 1"
06M = 6 mm OD
08M = 8 mm OD
10M = 10 mm OD
12M = 12 mm OD
25M = 25mm OD
Blank for Tube Vent,
Nut& Ferrules

N = NPT
G = BSPP
GT = BSPT
M = Metric
S = SAE
U = UNF

14 = 1/4"
38 = 3/8"
12 = 1/2"
34 = 3/4"
01 = 1"
06M = 6 mm OD
08M = 8 mm OD
10M = 10 mm OD
12M = 12 mm OD
25M = 25mm OD
Blank for Tube Vent,
Nut& Ferrules

NA = NACE MR 01-75
(Latest Edition)
OXY = Cleaned for
Oxygen service
BR = Bored thru
SPF = Silver Plated
Ferrule
VO = Viton 'O' ring

SS = SS 316
SSL = SS 316L
SSD = SS 316/316L Dual
SS4 = SS 304
MO = Monel 400
HC = Hastelloy C 276
DU = Duplex SS
SD = Super Duplex
IN6 = Inconel-625
IN8 = Inconel-825
CS = Carbon Steel
BR = Brass

TamiLok Instrument Tube Fittings are utilised in different instrumentation and process tube connections to provide a leak-proof, torque-free closure. Our products eliminate costly and perhaps harmful leaks.

Identification of metric & fractional

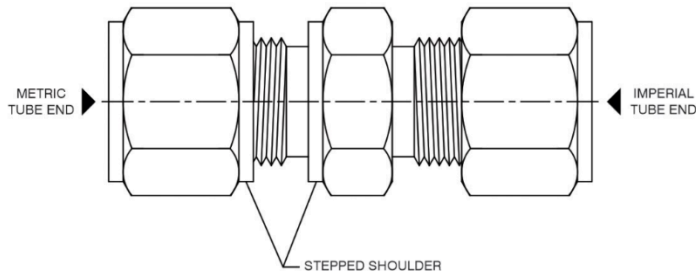

Material Standards

Our fittings are available in a variety of materials, as shown in the table below.

Materials	Barstock	Forgings
SS316/316L	ASTM A276, EN 1.4401	ASTM A182, EN 1.4401
6-Moly	ASTM A479	ASTM A182
Alloy 400	ASTM B164	ASTM B564
Alloy 600	ASTM B166	ASTM B564
Alloy 625	ASTM B446	ASTM B564
Alloy 825	ASTM B425	ASTM B564
Alloy C-276	ASTM B574	ASTM B564
Brass	ASTM B16, ASTM B453	ASTM B283
Carbon Steel	ASTM A108	-
Alloy 2507- Super Duplex	ASTM A479	ASTM A182
Titanium (Grade 4)	ASTM B348	ASTM B381

TABLE - 1

Compression fittings are rated for working pressure higher than the tubing. Therefore pressure rating depends

NPT / ISO PIPE SIZE INCH	SS 316 & Carbon steel	
	Male Threads (PSI)	Female Threads (PSI)
1/8" NPT	10000	6400
1/4" NPT	8300	6500
3/8" NPT	8000	5200
1/2" NPT	7800	4800
3/4" NPT	7500	4600
1" NPT	5300	4400

on choice of tubing which should be based on material. Wall thickness and temperature(see table below). Derating factors must be used to determine tubing working pressure at high temperatures.

Maximum Allowable Working Pressure For Fractional Size Tubing (Value in PSI)

TABLE - 2

Tubing O.D (inch)	Tubing wall thickness (inch). SS 316 & SS 304												
	0.010	0.012	0.014	0.016	0.020	0.028	0.035	0.049	0.065	0.083	0.095	0.109	0.120
1/16"	5600	6800	8100	9400	12000								
1/8"						8500	10900						
3/16"						5400	7000	10200					
1/4"						4000	5100	7500	10200				
5/16"							4000	5800	8000				
3/8"							3300	4800	6500				
1/2"							2600	3700	5100	6700			
5/8"								2900	4000	5200	6000		
3/4"								2400	3300	4200	4900	5800	
7/8"								2000	2800	3600	4200	4800	
1"									2400	3100	3600	4200	4700

Maximum Allowable Working Pressure For Metric Size Tubing (Value in BAR)

TABLE - 3

Tubing O.D (mm)	Tubing wall thickness (mm). SS 316 & SS 304									
	0.8	1.0	1.2	1.5	1.8	2.0	2.2	2.5	2.8	3.0
3	680									
6	320	430	550	720						
8		310	390	530						
10		240	310	410	510	580				
12		200	250	330	420	480				
14		160	200	270	340	390	430			
16			180	230	290	330	370			
18			150	210	260	290	330	380		
20			140	180	230	260	290	330	380	
22			120	170	210	240	260	300	340	
25					180	200	230	260	300	320

- AISI 304 and AISI 316 SS annealed seamless tubing ASTM A-269 or A-213 or equivalent
- Above mentioned working pressure is applicable only for -29°C to 38°C for AISI 304 & AISI 316/316L SS. For other temperature range use table 4 (Pressure rating at elevated temp.) for derating factor

Pressure Ratings at Elevated Temperatures

TABLE - 4

Temperature		Tubing Material	
F	C	SS 304/304L	SS 316/316L
200	93	1.00	1.00
400	204	0.93	0.96
600	315	0.82	0.85
800	426	0.76	0.8
1000	537	0.69	0.76

Male Connector

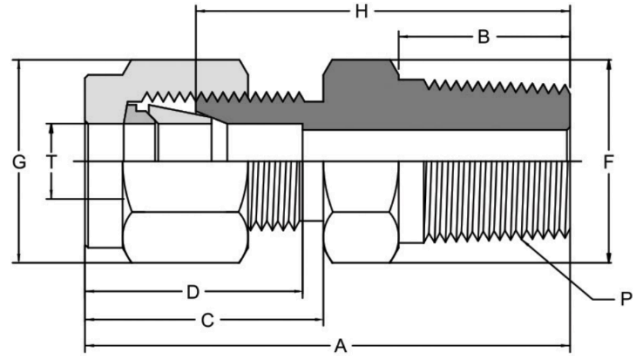

Imperial Range (Dimensions in Inches)

PART.NO	T O/D	P	A LENGTH	B	C	D	F BODY	G NUT	H BODY
MCI-1616	1/16	1/16	0.94	0.38	0.44	0.34	5/16	5/16	0.78
MCI-1618	1/16	1/8	1.00	0.38	0.44	0.34	7/16	5/16	0.84
MCI-1816	1/8	1/16	1.19	0.38	0.63	0.53	7/16	7/16	0.91
MCI-1818	1/8	1/8	1.19	0.38	0.63	0.53	7/16	7/16	0.91
MCI-1814	1/8	1/4	1.41	0.56	0.63	0.53	9/16	7/16	1.13
MCI-3618	3/16	1/8	1.21	0.38	0.63	0.54	7/16	1/2	0.65
MCI-3614	3/16	1/4	1.42	0.56	0.63	0.54	9/16	1/2	1.16
MCI-1416	1/4	1/16	1.29	0.38	0.70	0.60	1/2	9/16	1.00
MCI-1418	1/4	1/8	1.29	0.38	0.70	0.60	1/2	9/16	1.00
MCI-1414	1/4	1/4	1.50	0.56	0.72	0.63	9/16	9/16	1.19
MCI-1438	1/4	3/8	1.51	0.56	0.70	0.60	11/16	9/16	1.19
MCI-1412	1/4	1/2	1.73	0.75	0.70	0.60	7/8	9/16	1.44
MCI-5618	5/16	1/8	1.34	0.38	0.73	0.64	9/16	5/8	1.05
MCI-5614	5/16	1/4	1.52	0.56	0.73	0.64	9/16	5/8	1.23
MCI-3818	3/8	1/8	1.38	0.38	0.76	0.66	5/8	11/16	1.09
MCI-3814	3/8	1/4	1.57	0.56	0.76	0.66	5/8	11/16	1.28
MCI-3838	3/8	3/8	1.57	0.56	0.76	0.66	11/16	11/16	1.28
MCI-3812	3/8	1/2	1.79	0.75	0.76	0.66	7/8	11/16	1.50
MCI-3834	3/8	3/4	1.82	0.75	0.76	0.66	1-1/16	11/16	1.53
MCI-1214	1/2	1/4	1.71	0.56	0.86	0.90	13/16	7/8	1.31
MCI-1238	1/2	3/8	1.71	0.56	0.86	0.90	13/16	7/8	1.31
MCI-1212	1/2	1/2	1.90	0.75	0.86	0.90	7/8	7/8	1.50
MCI-1234	1/2	3/4	1.93	0.75	0.86	0.90	1-1/16	7/8	1.53
MCI-5838	5/8	3/8	1.74	0.56	0.86	0.96	15/16	1	1.34
MCI-5812	5/8	1/2	1.93	0.75	0.86	0.96	15/16	1	1.53
MCI-5834	5/8	3/4	1.93	0.75	0.86	0.96	1-1/16	1	1.53
MCI-3412	3/4	1/2	1.99	0.75	0.86	0.96	1-1/16	1-1/8	1.59
MCI-3434	3/4	3/4	1.99	0.75	0.86	0.96	1-1/16	1-1/8	1.59
MCI-3401	3/4	1	2.21	0.94	0.86	0.96	1-3/16	1-1/8	1.81
MCI-0134	1	3/4	2.26	0.75	1.04	1.23	1-3/8	1-1/2	1.78
MCI-0101	1	1	2.45	0.94	1.04	1.23	1-3/8	1-1/2	1.97

Matric Range (Dimensions in mm)

PART.NO	T O/D	P	A LENGTH	B	C	D	F BODY	G NUT	H BODY
MCM-0418	4	1/8	31.35	9.53	16.67	14.29	12	12	24.21
MCM-0414	4	1/4	35.72	14.29	16.67	14.29	14	12	29.37
MCM-0618	6	1/8	33.34	9.53	18.26	15.88	14	14	25.40
MCM-0614	6	1/4	33.34	14.29	18.26	15.88	14	14	30.16
MCM-0638	6	3/8	38.89	14.29	18.26	15.88	18	14	30.96
MCM-0612	6	1/2	44.45	19.05	18.26	15.88	22	14	36.51
MCM-0818	8	1/8	34.53	9.53	19.05	16.67	15	17	26.59
MCM-0814	8	1/4	39.29	14.29	19.05	16.67	15	17	31.35
MCM-1018	10	1/8	35.72	9.53	19.84	17.46	18	19	27.78
MCM-1014	10	1/4	40.48	14.29	19.84	17.46	18	19	32.54
MCM-1038	10	3/8	40.48	14.29	19.84	17.46	18	19	32.54
MCM-1012	10	1/2	46.04	19.05	19.84	17.46	22	19	38.10
MCM-1034	10	3/4	46.83	19.05	19.84	17.46	27	19	38.89
MCM-1214	12	1/4	43.66	14.29	22.23	23.02	22	22	33.34
MCM-1238	12	3/8	43.66	14.29	22.23	23.02	22	22	33.34
MCM-1212	12	1/2	48.42	19.05	22.23	23.02	22	22	38.10
MCM-1234	12	3/4	49.21	19.05	22.23	23.02	27	22	38.89
MCM-1638	16	3/8	44.45	14.29	22.23	24.61	24	27	34.13
MCM-1612	16	1/2	49.21	19.05	22.23	24.61	24	27	38.89
MCM-1634	16	3/4	49.21	19.05	22.23	24.61	27	27	38.89
MCM-1812	18	1/2	50.80	19.05	22.23	24.61	27	30	40.48
MCM-1834	18	3/4	50.80	19.05	22.23	24.61	27	30	40.48
MCM-1801	18	1	56.36	23.81	22.23	24.61	36	30	46.40
MCM-2012	20	1/2	50.80	19.05	22.23	24.61	30	30	40.48
MCM-2034	20	3/4	50.80	19.05	22.23	24.61	30	30	40.48
MCM-2001	20	1	56.36	23.81	22.23	24.61	35	30	46.04
MCM-2534	25	3/4	57.15	19.05	26.19	30.96	35	41	45.24
MCM-2501	25	1	61.91	23.81	26.19	30.96	35	41	50.01



Female Connector

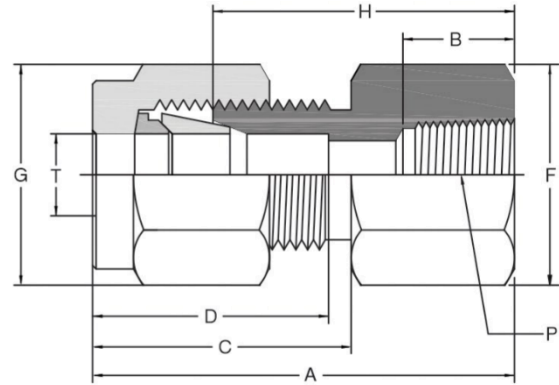
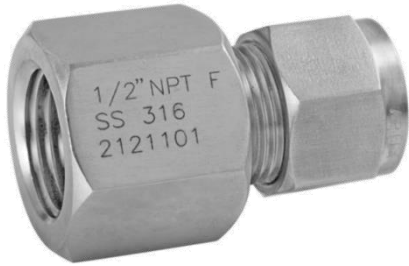

Imperial Range (Dimensions in Inches)

PART.NO	T O/D	P	A LENGTH	B	C	D	F BODY	G NUT	H BODY
FCI-1616	1/16	1/16	0.94	0.36	0.44	0.34	11/2	5/16	0.78
FCI-1818	1/8	1/8	1.16	0.39	0.63	0.53	9/16	7/16	0.88
FCI-1814	1/8	1/4	1.34	0.59	0.63	0.53	3/4	7/16	1.06
FCI-3618	3/16	1/8	1.17	0.39	0.63	0.54	9/16	9/16	0.91
FCI-1418	1/4	1/8	1.23	0.39	0.7	0.6	9/16	9/16	0.94
FCI-1414	1/4	1/4	1.41	0.59	0.7	0.6	3/4	9/16	1.12
FCI-1438	1/4	3/8	1.48	0.59	0.7	0.6	7/8	9/16	1.19
FCI-1412	1/4	1/2	1.7	0.78	0.7	0.6	1-1/16	9/16	1.41
FCI-5618	5/16	1/8	1.26	0.39	0.73	0.64	3/4	5/8	0.97
FCI-5614	5/16	1/4	1.45	0.59	0.73	0.64	3/4	5/8	1.16
FCI-3818	3/8	1/8	1.29	0.39	0.76	0.66	5/8	11/16	1
FCI-3814	3/8	1/4	1.48	0.59	0.76	0.66	3/4	11/16	1.19
FCI-3838	3/8	3/8	1.54	0.59	0.76	0.66	7/8	11/16	1.25
FCI-3812	3/8	1/2	1.73	0.78	0.76	0.66	1-1/16	11/16	1.44
FCI-1214	1/2	1/4	1.65	0.59	0.86	0.9	13/16	7/8	1.25
FCI-1238	1/2	3/8	1.65	0.59	0.86	0.9	7/8	7/8	1.25
FCI-1212	1/2	1/2	1.84	0.78	0.86	0.9	1-1/16	7/8	1.44
FCI-5838	5/8	3/8	1.65	0.59	0.86	0.96	15/16	1	1.25
FCI-5812	5/8	1/2	1.84	0.78	0.86	0.96	1-1/16	1	1.44
FCI-3412	3/4	1/2	1.84	0.78	0.86	0.96	1-1/16	1-1/8	1.44
FCI-3434	3/4	3/4	1.9	0.81	0.86	0.96	1-5/16	1-1/8	1.5
FCI-0134	1	3/4	2.1	0.81	1.04	1.23	1-3/8	1-1/2	1.62
FCI-0101	1	1	2.45	1	1.04	1.23	1-5/8	1-1/2	1.97

Matric Range (Dimensions in mm)

PART.NO	T O/D	P	A LENGTH	B	C	D	F BODY	G NUT	H BODY
FCM-0418	4	1/8"	30.16	10	16.67	14.29	14	12	23.02
FCM-0618	6	1/8"	31.75	10	18.26	15.88	14	14	23.81
FCM-0614	6	1/4"	36.51	14	18.26	15.88	19	14	28.58
FCM-0638	6	3/8"	38.07	14	18.26	15.88	22	14	30.16
FCM-0612	6	1/2"	43.66	19	18.26	15.88	27	14	35.72
FCM-0818	8	1/8"	32.54	10	19.05	16.67	14	17	24.61
FCM-0814	8	1/4"	37.31	14	19.05	16.67	19	17	29.37
FCM-0118	10	1/8"	33.34	10	19.84	17.46	17	19	25.4
FCM-0114	10	1/4"	38.1	14	19.84	17.46	19	19	30.16
FCM-0138	10	3/8"	39.69	14	19.84	17.46	22	19	31.75
FCM-0112	10	1/2"	44.45	19	19.84	17.46	27	19	36.51
FCM-1214	12	1/4"	42.07	14	22.23	23.02	22	22	31.75
FCM-1238	12	3/8"	42.07	14	22.23	23.02	22	22	31.75
FCM-1212	12	1/2"	46.83	19	22.23	23.02	27	22	36.51
FCM-1612	16	1/2"	46.83	19	22.23	24.61	27	27	36.51
FCM-1812	18	1/2"	46.83	19	22.23	24.61	27	30	36.51
FCM-1834	18	3/4"	48.42	19	22.23	24.61	32	30	38.1
FCM-2012	20	1/2"	46.83	19	22.23	24.61	27	30	36.51
FCM-2034	20	3/4"	48.42	19	22.23	24.61	32	30	38.1
FCM-2534	25	3/4"	53.18	19	26.19	31.75	36	41	41.28
FCM-2501	25	1"	61.91	24	26.19	30.96	41	41	50.01



Equal Union

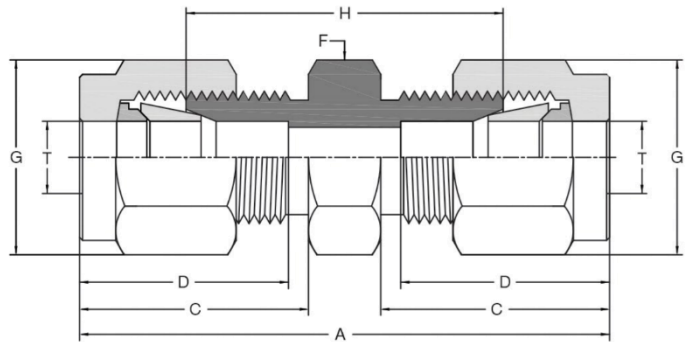

Imperial Range (Dimensions in Inches)

PART. NO.	TO/D	A LENGTH	C	D	F BODY	G NUT	H BODY
EUI-16	1/16	1.00	0.44	0.34	5/16	5/16	0.689
EUI-18	1/8	1.44	0.63	0.53	1/2	7/16	0.881
EUI-36	3/16	1.47	0.63	0.54	7/16	1/2	0.945
EUI-14	1/4	1.61	0.70	0.60	0.551	9/16	1.043
EUI-56	5/16	1.68	0.73	0.64	0.551	5/8	1.102
EUI-38	3/8	1.77	0.76	0.66	5/8	11/16	1.189
EUI-12	1/2	2.02	0.86	0.90	7/8	7/8	1.220
EUI-58	5/8	2.05	0.86	0.96	0.945	1	1.26
EUI-34	3/4	2.11	0.86	0.96	1.102	1-1/8	1.319
EUI-01	1	2.55	1.04	1.23	1.417	1-1/2	1.594

Matric Range (Dimensions in mm)

PART. NO.	TO/D	A LENGTH	C	D	F BODY	G NUT	H BODY
EUM-04	4	38.5	16.67	14.29	12	12	24.21
EUM-06	6	42.07	18.26	15.88	14	14	26.19
EUM-08	8	44.04	19.05	16.67	14	17	28.18
EUM-10	10	46.04	19.84	17.46	17	19	31
EUM-12	12	51.59	22.23	23.01	22	22	31
EUM-16	16	52.39	22.23	24.61	24	25	32
EUM-18	18	53.98	22.23	24.61	27	30	33.34
EUM-20	20	55	22.23	24.61	27	32	34
EUM-25	25	64.29	26.19	30.96	36	38	40.48

Unequal Union

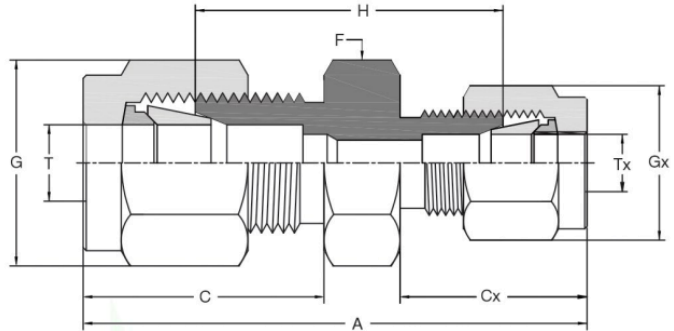

Imperial Range (Dimensions in Inches)

PART NO.	T O/D	TX O/D	A LENGTH	C	CX	F BODY	G NUT	GX NUT	H BODY
UUI - 1816	1//8	1//16	1.25	0.63	0.44	1//2	7//16	5 // 16	0.81
UUI - 3618	3//16	1//8	1.48	0.66	0.63	1//2	1//2	7//16	0.92
UUI - 1416	1//4	1//16	1.37	0.72	0.44	1//2	9//16	5// 16	0.91
UUI - 1418	1//4	1//8	1.56	0.72	0.63	1//2	9//16	7//16	0.97
UUI - 1436	1//4	3//16	1.55	0.70	0.63	1//2	9//16	1//2	1.00
UUI - 5614	5//16	1//4	1.66	0.73	0.70	9//16	5//8	9//16	1.08
UUI - 3814	3//8	1//4	1.70	0.76	0.70	5//8	11//16	9//16	1.12
UUI - 3856	3//8	5//16	1.74	0.76	0.73	5//8	11//16	5//8	1.16
UUI - 1214	1//2	1//4	1.85	0.86	0.70	3//16	7//8	9//16	1.16
UUI - 1238	1//2	3//8	1.91	0.86	0.76	13//16	7//8	11//16	1.22
UUI - 5638	5//6	3//8	1.94	0.86	0.76	15//16	1	11//16	1.25
UUI - 5812	5//8	1//2	2.05	0.86	0.86	15//16	1	7//8	1.25
UUI - 3412	3//4	1//2	2.11	0.86	0.86	1 - 1/16	1 - 1/8	7//8	1.31
UUI - 3458	3//4	5//8	2.11	0.86	0.86	1 - 1/16	1 - 1/8	1	1.31
UUI - 0134	1	3//4	2.47	1.04	0.86	1 - 3/8	1 - 1/2	1-1/8	1.59

Matric Range (Dimensions in mm)

PART NO.	T O/D	Tx O/D	A LENGTH	C	D	FBODY	G NUT	Gx NUT	H BODY
UUM-0604	6	4	40.48	19.97	19.05	14	14	12	25.4
UUM-0804	8	6	43.26	19.05	19.97	14	17	14	27.38
UUM-1006	10	6	44.45	19.84	19.97	17	19	14	28.58
UUM-1008	10	8	45.24	19.84	19.05	17	19	17	29.37
UUM-1206	12	6	47.63	22.23	19.97	22	22	14	29.37
UUM-1210	12	10	49.21	22.23	19.84	22	22	19	30.96
UUM-1610	16	10	50.01	22.23	19.84	24	27	19	31.75
UUM-1612	16	12	52.39	22.23	22.23	24	27	22	31.75
UUM-2012	20	12	53.98	22.23	22.23	27	30	22	33.34
UUM-2016	20	16	53.98	22.23	22.23	27	30	27	33.34
UUM-2520	25	20	60.32	26.19	22.23	36	41	30	38.1

Bulkhead Male Connector

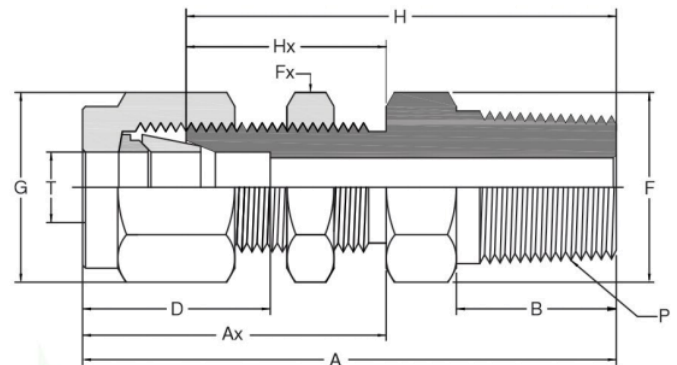

Imperial Range (Dimensions in Inches)

PART NO.	T O/D	P	B	D	F BODY	G NUT	Fx	H	Ax	Hx	A	PANEL HOLE	MAX PANEL
BMCI-1418	1/4	1/8	0.38	0.60	5/8	9/16	5/8	1.66	1.32	1.03	1.95	29/64	0.40
BMCI-1414	1/4	1/4	0.56	0.60	5/8	9/16	5/8	1.81	1.32	1.03	2.10	29/64	0.40
BMCI-3814	3/8	1/4	0.56	0.66	3/4	11/16	3/4	1.97	1.45	1.16	2.26	37/64	0.44
BMCI-1212	1/2	1/2	0.75	0.90	15/16	7/8	15/16	2.28	1.65	1.25	2.68	49/64	0.50

Bulkhead Female Connector

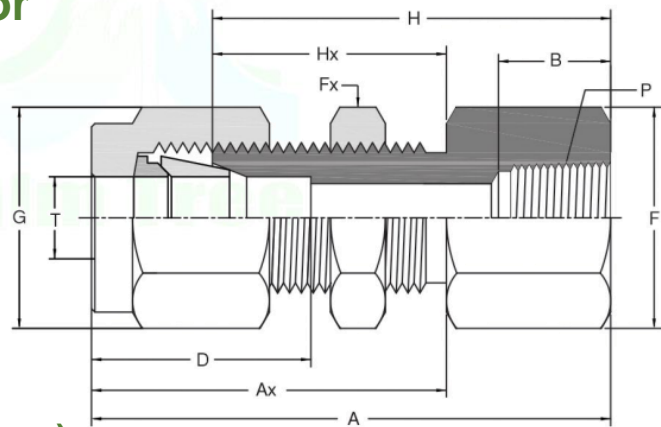

Imperial Range (Dimensions in Inches)

PART NO.	T O/D	P	B	D	F BODY	G NUT	Fx	H	Ax	Hx	A	PANEL HOLE	MAX PANEL
BFCI-1418	1/4	1/8	0.39	0.60	5/8	9/16	5/8	1.56	1.32	1.32	1.85	0.453	0.40
BFCI-1414	1/4	1/4	0.59	0.60	3/4	9/16	5/8	1.75	1.32	1.32	2.04	0.453	0.40
BFCI-3814	3/8	1/4	0.59	0.66	3/4	11/16	3/4	1.88	1.45	1.45	2.17	0.579	0.44
BFCI-1238	1/2	3/8	0.59	0.90	0.945	7/8	0.945	2.03	1.65	1.65	2.43	0.768	0.50
BFCI-1212	1/2	1/2	0.78	0.90	1.063	7/8	0.945	2.22	1.65	1.65	2.62	0.768	0.50

Matric Range (Dimensions in mm)

PART NO.	T O/D	P	B	D	F BODY	G NUT	Fx	H	Ax	Hx	A	PANEL HOLE	MAX PANEL
BFCM-0614	6	1/4	14	15.88	19	14	16	44.5	33.5	26.2	51.9	11.5	10.2
BFCM-1212	12	1/2	19	23.02	27	22	24	56.4	41.9	31.8	66.5	19.5	12.7

Bulkhead Union

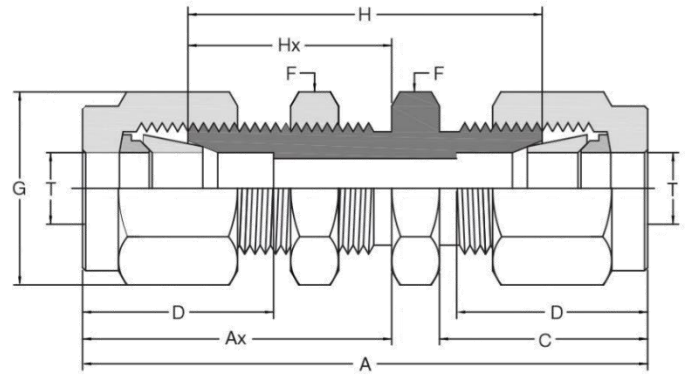

Imperial Range (Dimensions in Inches)

PART NO.	T O/D	A LENGTH	C	D	F BODY	G NUT	H
BUI-16	1/16	1.24	0.43	0.34	5/16	5/16	0.94
BUI-18	1/8	2.02	0.60	0.50	1/2	7/16	1.50
BUI-36	3/16	2.11	0.63	0.54	9/16	1/2	1.59
BUI-14	1/4	2.27	0.70	0.60	5/8	9/16	1.69
BUI-56	5/16	2.39	0.73	0.64	11/16	5/8	1.81
BUI-38	3/8	2.45	0.76	0.66	3/4	11/16	1.87
BUI-12	1/2	2.80	0.86	0.90	15/16	7/8	2.00
BUI-58	5/8	2.86	0.86	0.96	1-1/16	1	2.06
BUI-34	3/4	3.11	0.86	0.96	1-3/16	1-1/8	2.31
BUI-01	1	3.77	1.04	1.23	1-5/8	1-1/2	2.81

Matric Range (Dimensions in mm)

PART NO.	T O/D	A LENGTH	C	D	F BODY	G NUT	H BODY	Ax	Hx
BUM-03	3	51.3	15.3	12.9	14	12	38.1	31.0	24.6
BUM-04	4	53.6	16.1	13.7	14	12	40.4	32.0	25.4
BUM-06	6	57.7	17.7	15.3	16	14	42.9	33.6	26.2
BUM-08	8	61.0	18.6	16.2	18	16	46.0	36.1	28.6
BUM-10	10	63.7	19.5	17.2	22	19	48.5	37.0	29.4
BUM-12	12	71.0	22.0	22.8	24	22	50.8	41.9	31.8
BUM-16	16	72.5	22.0	24.0	27	25	52.3	42.6	32.5
BUM-20	20	84.5	22.0	26.0	35	32	64.3	53.0	42.9

Union Elbow

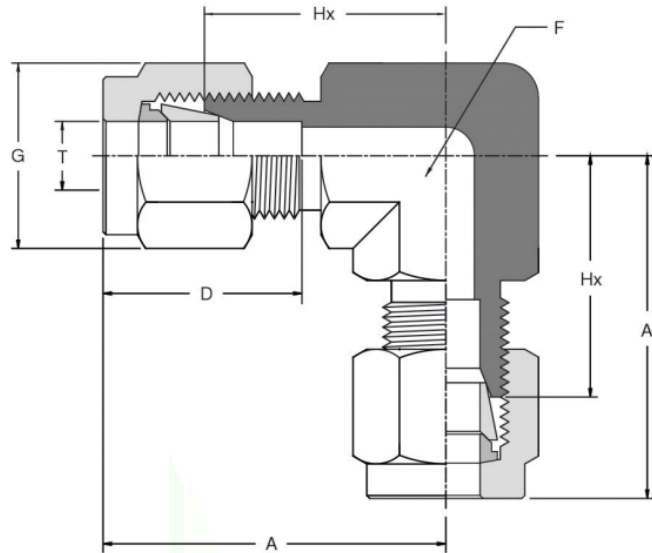

Imperial Range (Dimensions in Inches)

PART. NO	T O/D	A LENGTH	D	F BODY	G NUT	Hx BODY
UEI-16	1/16	17.8	0.34	0.433	5/16	0.56
UEI-18	1/8	22.4	0.53	1/2	7/16	0.72
UEI-36	3/16	26	0.54	1/2	1/2	0.75
UEI-14	1/4	27	0.60	0.551	9/16	0.78
UEI-56	5/16	29	0.64	10.630	5/81	0.88
UEI-38	3/8	31	0.66	0.630	1/16	0.91
UEI-12	1/2	36	0.90	7/8	7/8	0.98
UEI-58	5/8	38	0.96	0.945	1	1.06
UEI-34	3/4	40	0.96	1.0630	1-1/8	1.11
UEI-01	1	49	1.23	1.380	1-1/2	1.31

Matric Range (Dimensions in mm)

PART. NO	T O/D	A LENGTH	D	F BODY	G NUT	Hx BODY
UEM-04	4	24.61	14.29	12	12	19.05
UEM-06	6	27	15.88	12	14	19.81
UEM-08	8	29	16.67	16	17	22.23
UEM-10	10	31	17.46	16	19	23.11
UEM-12	12	36	23.02	22	22	24.89
UEM-16	16	38	24.61	24	27	26.19
UEM-18	18	40	24.61	27	30	29.37
UEM-20	20	44	24.61	27	30	29.37
UEM-25	25	50	30.96	32	41	33.34

Tube Fittings



Male Elbow

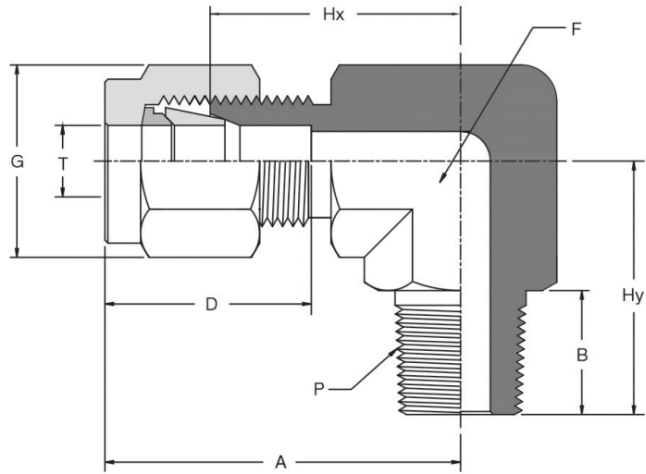

Imperial Range (Dimensions in Inches)

PART. NO	T O/D	P	A LENGTH	B	HY	D	F BODY	G NUT	HX BODY
MEI-1616	1/16	1/16	3/4	0.38	0.690	0.34	0.47	5/16	5/8
MEI-1618	1/16	1/8	3/4	0.38	0.708	0.34	0.47	5/16	5/8
MEI-1816	1/8	1/16	1	0.38	0.748	0.51	0.47	7/16	0.708
MEI-1818	1/8	1/8	0.945	0.38	0.748	0.53	0.47	7/16	0.708
MEI-1814	1/8	1/4	0.945	0.56	0.945	0.53	0.47	7/16	0.945
MEI-3618	3/16	1/8	1	0.38	0.768	0.54	0.47	1/2	3/4
MEI-1418	1/4	1/8	1.063	0.38	0.768	0.60	0.47	9/16	0.787
MEI-1414	1/4	1/4	1.063	0.56	0.945	0.60	0.47	9/16	0.945
MEI-1438	1/4	3/8	1.181	0.56	1.024	0.60	0.55	9/16	0.866
MEI-1412	1/4	1/2	1.260	0.75	1.299	0.60	0.75	9/16	0.945
MEI-5618	5/16	1/8	1.181	0.38	0.787	0.64	0.55	5/8	0.866
MEI-5614	5/16	1/4	1.181	0.56	1	0.64	0.55	5/8	0.866
MEI-3818	3/8	1/8	1.220	0.38	0.787	0.66	0.55	11/16	0.945
MEI-3814	3/8	1/4	1.220	0.56	1	0.66	0.55	11/16	0.945
MEI-3838	3/8	3/8	1.240	0.56	1.024	0.66	0.55	11/16	0.945
MEI-3812	3/8	1/2	1.338	0.75	1.299	0.66	0.75	11/16	1
MEI-1214	1/2	1/4	1.417	0.56	1.102	0.91	0.75	7/8	1
MEI-1238	1/2	3/8	1.417	0.56	1.102	0.91	0.75	7/8	1
MEI-1212	1/2	1/2	1.456	0.75	1.299	0.91	0.75	7/8	1
MEI-5838	5/8	3/8	1.496	0.56	1.181	0.96	0.94	1	1.063
MEI-5812	5/8	1/2	1.496	0.75	1.338	0.96	0.94	1	1.063
MEI-3412	3/4	1/2	1.535	0.75	1.417	0.96	1.06	1-1/8	1.141
MEI-3434	3/4	3/4	1.535	0.75	1.417	0.96	1.06	1-1/8	1.141
MEI-0134	1	3/4	1.929	0.94	1.654	1.23	1.25	1-1/2	1.338
MEI-0101	1	1	1.929	0.94	1.850	1.23	1.25	1-1/2	1.338

Matric Range (Dimensions in mm)

PART. NO	T O/D	P	A LENGTH	B	HY	D	F BODY	G NUT	HX BODY
MEM-0418	4	1/8"	24.61	19.53	19.30	14.29	12	12	19.05
MEM-0618	6	1/8"	26.19	9.53	19.84	15.88	12	14	19.80
MEM-0614	6	1/4"	26.19	14.29	23.81	15.88	14	14	19.80
MEM-0638	6	3/8"	27.60	14.29	23.58	15.88	19	14	21.33
MEM-0612	6	1/2"	29.40	19.05	33.24	15.88	22	14	23.11
MEM-0818	8	1/8"	28.58	9.53	20.64	16.67	17	17	22.22
MEM-0814	8	1/4"	28.58	14.29	25.40	16.67	14	17	22.22
MEM-0838	8	3/8"	28.58	14.24	25.40	16.67	19	17	22.22
MEM-0812	8	1/2"	31.75	19.05	32.00	16.67	22	17	24.00
MEM-1018	10	1/8"	28.90	9.53	22.23	17.46	19	19	23.11
MEM-1014	10	1/4"	28.90	14.29	25.40	17.46	19	19	23.11
MEM-1038	10	3/8"	28.90	14.29	28.58	17.46	19	19	23.11
MEM-1012	10	1/2"	30.60	19.05	31.75	17.46	22	19	24.89
MEM-1214	12	1/4"	35.80	14.29	28.58	23.02	22	22	24.89
MEM-1238	12	3/8"	35.80	14.29	28.58	23.02	22	22	24.89
MEM-1212	12	1/2"	35.80	19.05	33.34	23.02	22	22	24.89
MEM-1638	16	3/8"	36.51	14.29	31.75	24.61	19	27	26.19
MEM-1612	16	1/2"	36.51	19.05	34.93	24.61	19	27	26.19
MEM-1812	18	1/2"	39.69	19.05	38.10	24.61	27	30	29.37
MEM-1834	18	3/4"	39.69	19.05	38.10	24.61	27	30	29.37
MEM-2012	20	1/2"	39.69	19.05	38.10	24.61	27	30	29.37
MEM-2034	20	3/4"	39.69	19.05	38.10	24.61	27	30	29.37
MEM-2534	25	3/4"	45.24	19.05	38.10	26.19	32	41	33.34
MEM-2501	25	1"	45.24	23.81	46.83	30.96	32	41	33.34



Female Elbow

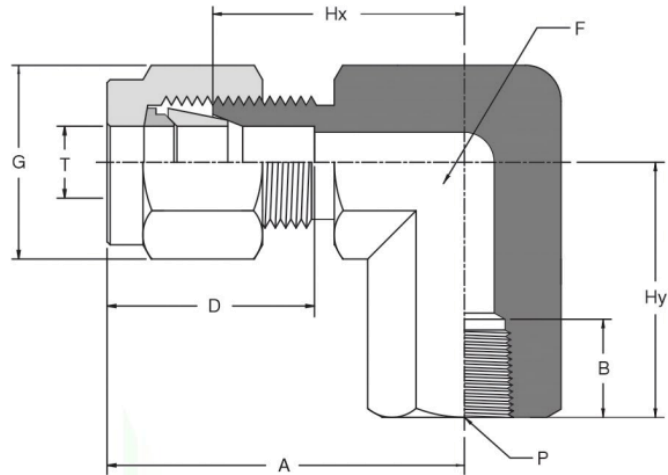

Imperial Range (Dimensions in Inches)

PART. NO	T O/D	P	A LENGTH	B	HY	D	F BODY	G NUT	HX BODY
FEI-1818	1/8	1/8	0.95	0.39	0.15	0.50	0.551	7/16	0.708
FEI-1814	1/8	1/4	1.07	0.59	0.88	0.50	0.748	7/16	0.825
FEI-3618	3/16	1/8	0.98	0.39	0.75	0.54	0.551	1/2	0.703
FEI-1418	1/4	1/8	1.04	0.39	0.75	0.60	0.551	9/16	0.749
FEI-1414	1/4	1/4	1.17	0.59	0.88	0.60	0.630	9/16	0.886
FEI-5618	5/16	1/8	1.17	0.39	0.75	0.64	0.551	5/8	0.866
FEI-5614	5/16	1/4	1.20	0.59	0.88	0.64	0.748	5/8	0.905
FEI-3818	3/8	1/8	1.20	0.39	0.75	0.66	0.748	11/16	0.905
FEI-3814	3/8	1/4	1.23	0.59	0.88	0.66	0.748	11/16	0.945
FEI-3838	3/8	3/8	1.32	0.59	0.88	0.66	0.748	11/16	1.027
FEI-3812	3/8	1/2	1.41	0.78	1.12	0.66	1.102	11/16	1.102
FEI-1214	1/2	1/4	1.38	0.59	0.88	0.90	0.748	7/8	1.000
FEI-1238	1/2	3/8	1.43	0.59	0.88	0.90	0.748	7/8	1.023
FEI-1212	1/2	1/2	1.52	0.78	1.12	0.90	1.102	7/8	1.142
FEI-5838	5/8	3/8	1.46	0.59	0.88	0.96	0.748	1	1.102
FEI-5812	5/8	1/2	1.52	0.78	1.12	0.96	1.102	1	1.142
FEI-3412	3/4	1/2	1.51	0.78	1.12	0.96	1.102	1-1/8	1.102
FEI-3434	3/4	3/4	1.65	0.81	1.25	0.96	1.102	1-1/8	1.260

Equal Union Cross

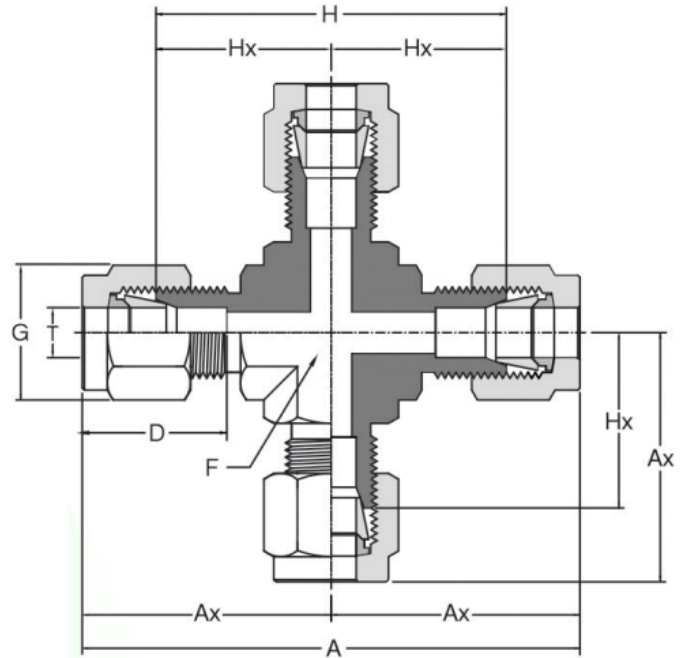

Imperial Range (Dimensions in Inches)

PART. NO	T O/D	AX LENGTH	D	F BODY	G NUT	HX BODY	H	A
UCI-18	1/8	0.99	0.53	1/2	7/16	0.72	1.44	1.98
UCI-36	3/16	1.01	0.54	1/2	1/2	0.75	1.50	2.02
UCI-14	1/4	1.07	0.60	9/16	9/16	0.78	1.56	2.14
UCI-56	5/16	1.17	0.64	5/8	5/8	0.88	1.76	2.34
UCI-38	3/8	1.2	0.66	5/8	1/16	0.91	1.82	2.40
UCI-12	1/2	1.38	0.90	7/8	7/8	0.98	1.96	2.76
UCI-58	5/8	1.46	0.96	0.81	1	1.06	2.12	2.92

Metric Range (Dimensions in mm)

PART. NO	T O/D	AX LENGTH	D	F BODY	G NUT	HX BODY	H	A
UCM-04	4	26.15	14.29	12	12	19.00	38.00	52.30
UCM-06	6	27.20	15.88	14	14	19.80	39.60	54.40
UCM-08	8	29.70	16.67	16	17	22.20	44.40	59.40
UCM-10	10	30.80	17.46	16	19	23.10	46.20	61.60
UCM-12	12	35.00	23.02	22	22	24.90	49.80	70.00
UCM-16	16	36.39	24.61	24	27	26.19	52.39	72.78

Union Tee

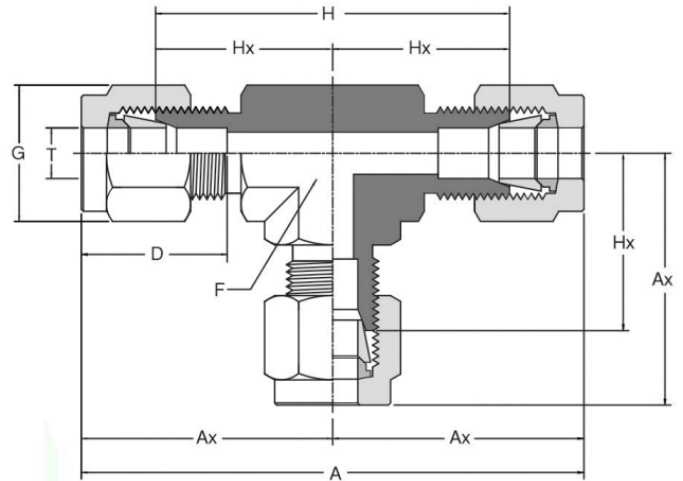

Imperial Range (Dimensions in Inches)

PART. NO	T O/D	AX LENGTH	D	F BODY	G NUT	HX BODY	H	A
UTI-16	1/16	0.72	0.34	0.47	5/16	0.56	1.12	1.44
UTI-18	1/8	0.99	0.50	0.47	7/16	0.72	1.44	1.98
UTI-36	3/16	1.01	0.54	0.47	1/2	0.75	1.50	2.02
UTI-14	1/4	1.07	0.60	0.47	9/16	0.78	1.56	2.25
UTI-56	5/16	1.17	0.64	0.55	5/8	0.88	1.76	2.34
UTI-38	3/8	1.20	0.66	0.55	11/16	0.91	1.82	2.40
UTI-12	1/2	1.30	0.90	0.75	7/8	0.98	1.96	2.76
UTI-58	5/8	1.46	0.96	0.94	1	1.06	2.12	2.92
UTI-34	3/4	1.51	0.96	1.06	1-1/8	1.11	2.22	3.02
UTI-01	1	1.79	1.23	1.25	1-1/2	1.31	2.62	3.58

Matric Range (Dimensions in mm)

PART. NO	T O/D	AX LENGTH	D	F BODY	G NUT	HX BODY	H	A
UTM-04		36.15	14.29	12	12	19.00	38.00	52.30
UTM-06	6	27.20	15.88	12	14	19.80	39.60	54.40
UTM-08	8	29.70	16.67	14	17	22.20	44.40	59.40
UTM-10	10	30.80	17.46	14	19	23.10	46.20	61.60
UTM-12	12	35.00	23.02	19	22	24.90	49.80	70.00
UTM-16	16	36.39	24.61	24	27	26.19	52.39	72.78
UTM-18	18	39.37	24.61	27	30	29.37	58.74	78.74
UTM-20	20	39.37	24.61	27	30	29.37	58.74	78.74
UTM-25	25	45.24	30.96	32	41	33.54	67.08	90.48

Tube Fittings



Male Branch Tee

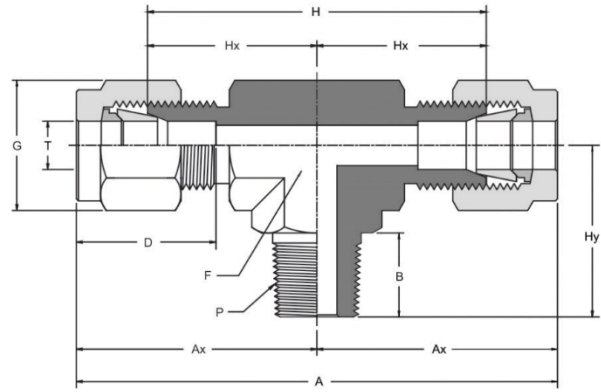

Imperial Range (Dimensions in Inches)

PART NO.	T O/D	P	AX LENGTH	B	HY	F	G NUT	HX BODY	H	A
BTI-1818	1/8	1/8	0.99	0.38	0.76	1/2	7/16	0.72	1.44	1.98
BTI-1814	1/8	1/4	0.99	0.56	0.94	0.551	7/16	0.72	1.44	1.98
BTI-3618	3/16	1/8	1.01	0.38	0.76	1/2	1/2	0.75	1.50	2.02
BTI-1418	1/4	1/8	1.07	0.38	0.76	1/2	9/16	0.78	1.56	2.14
BTI-1414	1/4	1/4	1.07	0.56	0.94	0.551	9/16	0.78	1.56	2.14
BTI-1438	1/4	3/8	1.13	0.56	1.00	3/4	9/16	0.84	1.68	2.26
BTI-5618	5/16	1/8	1.16	0.38	0.82	3/4	5/8	0.87	1.74	2.32
BTI-3818	3/8	1/8	1.21	0.38	0.82	3/4	1/16	0.91	1.82	2.42
BTI-3814	3/8	1/4	1.21	0.56	1.00	3/4	11/16	0.91	1.82	2.42
BTI-3838	3/8	3/8	1.21	0.56	1.00	3/4	11/16	0.91	1.82	2.42
BTI-3812	3/8	1/2	1.21	0.75	1.26	7/8	11/16	0.91	1.82	2.42
BTI-1214	1/2	1/4	1.38	0.56	1.08	7/8	7/8	0.98	1.96	2.76
BTI-1238	1/2	3/8	1.38	0.56	1.08	7/8	7/8	0.98	1.96	2.76
BTI-1212	1/2	1/2	1.38	0.75	1.26	7/8	7/8	0.98	1.96	2.76
BTI-5812	5/8	1/2	1.46	0.75	1.38	0.945	1	1.06	2.12	2.92

Matric Range (Dimensions in mm)

PART NO.	T O/D	P	AX LENGTH	B	HY	F	G NUT	HX BODY	H	A
BTM-0416	4	1/16	26.15	9.53	19.30	12	12	19.05	38.10	52.30
BTM-0418	4	1/8	26.15	9.53	19.53	12	12	19.05	38.10	52.30
BTM-0414	4	1/4	26.15	14.29	23.90	12	12	19.05	38.10	52.30
BTM-0618	6	1/8	27.21	9.53	19.30	14	14	19.80	39.60	54.42
BTM-0614	6	1/4	27.21	14.29	23.90	14	14	19.80	39.60	54.42
BTM-0638	6	3/8	29.00	14.29	25.40	19	14	21.33	42.66	57.46
BTM-0612	6	1/2	30.51	19.05	32.00	22	14	23.10	46.20	61.00
BTM-0818	8	1/8	29.70	9.53	20.80	19	17	22.22	44.44	59.40
BTM-0814	8	1/4	29.70	14.29	25.40	19	17	22.22	44.44	59.40
BTM-0838	8	3/8	29.70	14.29	25.40	19	17	22.22	44.44	59.40
BTM-0812	8	1/2	31.50	19.05	32.00	22	17	24.00	48.00	63.00
BTM-1018	10	1/8	30.80	9.53	20.80	19	19	23.10	46.20	61.60
BTM-1014	10	1/4	30.80	14.29	25.40	19	19	23.10	46.20	61.60
BTM-1038	10	3/8	30.80	14.29	25.40	19	19	23.10	46.20	61.60
BTM-1012	10	1/2	32.59	19.05	32.00	19	19	24.89	49.78	65.18
BTM-1214	12	1/4	34.99	14.29	27.40	22	22	24.89	49.78	69.98
BTM-1238	12	3/8	32.59	14.29	27.40	22	22	24.89	49.78	65.18
BTM-1212	12	1/2	32.59	19.05	32.00	22	22	24.89	49.78	65.18
BTM-1612	16	1/2	36.39	19.05	34.90	24	27	26.19	52.39	72.78

Tube Fittings



Male Run Tee

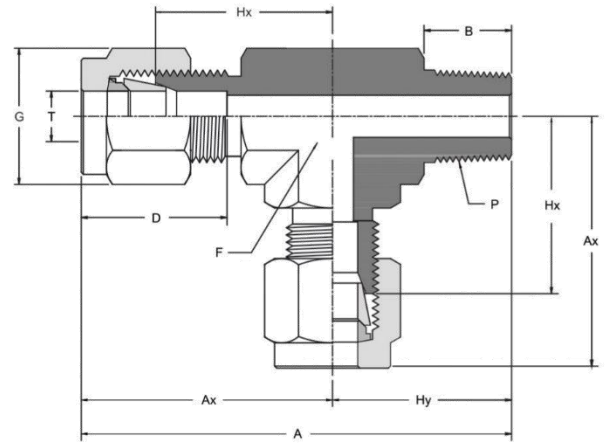

Imperial Range (Dimensions in Inches)

PART NO.	T O/D	P	AX LENGTH	B	HY	F	G NUT	HX BODY	H	A
RTI-1818	1/8	1/8	1.00	0.38	0.76	0.47	7/16	0.72	1.48	1.76
RTI-1814	1/8	1/4	1.00	0.56	0.94	0.47	7/16	0.72	1.66	1.94
RTI-3618	3/16	1/8	1.00	0.38	0.76	0.47	1/2	0.75	1.51	1.76
RTI-1418	1/4	1/8	1.07	0.38	0.76	0.47	9/16	0.78	1.54	1.83
RTI-1414	1/4	1/4	1.07	0.56	0.94	0.47	9/16	0.78	1.72	2.01
RTI-5618	5/16	1/8	1.16	0.38	0.82	0.55	5/8	0.87	1.70	1.98
RTI-3814	3/8	1/4	1.21	0.56	1.00	0.55	1/16	0.91	1.91	2.21
RTI-1238	1/2	3/8	1.38	0.56	1.08	0.74	7/8	0.98	2.06	2.46
RTI-1212	1/2	1/2	1.38	0.75	1.26	0.74	7/8	0.98	2.24	2.64
RTI-5812	5/8	1/2	1.47	0.75	1.38	0.74	1	1.06	2.40	2.85

Matric Range (Dimensions in mm)

PART NO.	T O/D	P	AX LENGTH	B	HY	F	G NUT	HX BODY	H	A
RTM-0416	4	1/16	26.15	9.53	19.30	12	12	19.05	38.10	45.45
RTM-0418	4	1/8	26.15	9.53	19.30	12	12	19.05	38.10	45.45
RTM-0414	4	1/4	26.15	14.29	23.88	12	12	19.05	38.10	50.03
RTM-0618	6	1/8	27.21	9.53	19.30	12	14	19.81	39.62	46.51
RTM-0614	6	1/4	27.21	14.29	23.88	14	14	19.81	39.62	51.09
RTM-0638	6	3/8	28.74	14.29	25.40	19	14	21.34	42.68	54.14
RTM-0612	6	1/2	30.51	19.05	32.00	22	14	23.11	43.22	62.51
RTM-0818	8	1/8	29.73	9.53	20.83	19	17	22.23	44.46	50.56
RTM-0814	8	1/4	29.73	14.29	25.40	19	17	22.23	44.46	55.13
RTM-0838	8	3/8	29.73	14.29	25.40	19	17	22.23	44.46	55.13
RTM-0812	8	1/2	31.50	19.05	32.00	22	17	24.00	48.00	63.50
RTM-1018	10	1/8	30.81	9.53	20.83	19	19	23.11	46.22	51.64
RTM-1014	10	1/4	30.81	14.29	25.40	19	19	23.11	46.22	56.21
RTM-1038	10	3/8	30.81	14.29	25.40	19	19	23.11	46.22	56.21
RTM-1012	10	1/2	32.59	19.05	32.00	22	19	24.89	49.78	64.59
RTM-1214	12	1/4	34.99	14.29	27.43	22	22	24.89	49.78	62.42
RTM-1238	12	3/8	34.99	14.29	27.43	22	22	24.89	49.78	62.42
RTM-1212	12	1/2	34.99	19.05	32.00	22	22	24.89	49.78	66.99
RTM-1612	16	1/2	36.39	19.05	34.30	25	27	26.19	52.38	71.32

Tube Fittings



Female Branch Tee

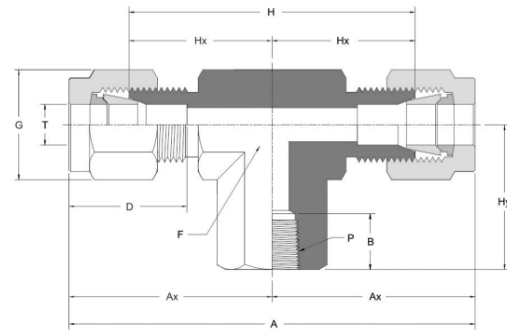

Imperial Range (Dimensions in Inches)

PART NO.	T O/D	P	AX LENGTH	B	HY	F	G NUT	HX BODY	H	A
FBTI-1818	1/8	1/8	0.97	0.38	0.75	1/2	7/16	0.72	0.70	1.94
FBTI-1418	1/4	1/8	1.06	0.38	0.75	1/2	9/16	0.78	0.77	2.12
FBTI-1414	1/4	1/4	1.17	0.56	0.88	3/4	9/16	0.78	0.88	2.34
FBTI-3814	3/8	1/4	1.23	0.56	0.88	3/4	11/16	0.91	0.94	2.46
FBTI-1214	1/2	1/4	1.42	0.56	0.88	13/16	7/8	0.98	1.02	2.84
FBTI-1238	1/2	3/8	1.42	0.56	0.88	7/8	7/8	0.98	1.02	2.84
FBTI-1212	1/2	1/2	1.53	0.75	1.12	1-1/16	7/8	0.98	1.13	3.06

Metric Range (Dimensions in mm)

PART NO.	T O/D	P	AX LENGTH	B	HY	F	G NUT	HX BODY	H	A
FBTM-0618	6	1/8	26.95	10	19.0	14	14	19.6	39.2	53.9
FBTM-0614	6	1/4	29.75	14	22.4	19	14	22.4	44.8	59.5
FBTM-0818	8	1/8	29.85	10	19.0	15	17	22.4	44.8	59.7
FBTM-0814	8	1/4	30.60	14	22.4	19	17	22.4	44.8	61.2
FBTM-1014	10	1/4	33.50	14	22.4	20.6	19	25.9	51.8	67.0
FBTM-1214	12	1/4	36.00	14	22.4	20.6	22	25.9	51.8	72.0
FBTM-1238	12	3/8	36.00	14	22.4	22	22	25.9	51.8	72.0
FBTM-1212	12	1/2	38.85	19	28.5	27	22	28.7	57.4	77.7

Female Run Tee

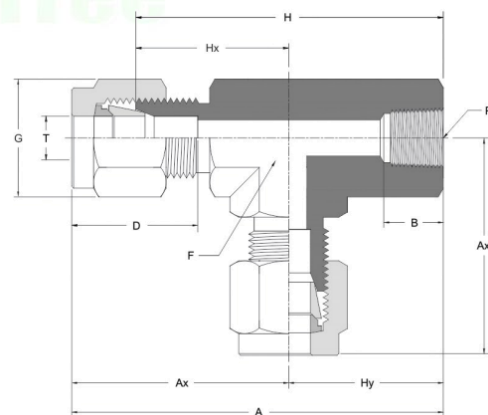

Imperial Range (Dimensions in Inches)

PART NO.	T O/D	P	AX LENGTH	B	HY	F	G NUT	HX BODY	H	A
FRTI-1818	1/8	1/8	1.00	0.38	0.75	1/2	7/16	0.72	1.45	1.75
FRTI-1418	1/4	1/8	1.07	0.38	0.81	1/2	9/16	0.78	1.52	1.88
FRTI-1414	1/4	1/4	1.07	0.56	0.88	3/4	9/16	0.78	1.76	1.95
FRTI-3814	3/8	1/4	1.21	0.56	0.88	3/4	11/16	0.91	1.82	2.09
FRTI-1214	1/2	1/4	1.21	0.56	0.88	13/16	7/8	0.98	1.90	2.26
FRTI-1238	1/2	3/8	1.38	0.56	0.88	7/8	7/8	0.98	2.90	2.26
FRTI-1212	1/2	1/2	1.38	0.75	1.12	1-1/16	7/8	0.98	2.26	2.50

Tube Union Cap

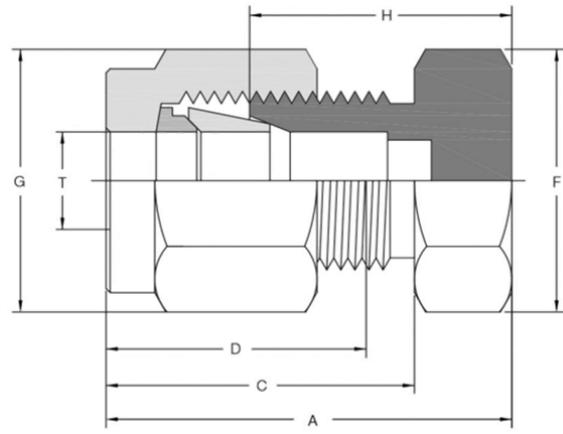

Imperial Range (Dimensions in Inches)

PART NO.	T O/D	A LENGTH	C	D	F BODY	G NUT	H BODY
CI-36	3/16	0.84	0.63	0.54	7/16	1/2	0.58
CI-14	1/4	0.92	0.70	0.60	1/2	9/16	0.63
CI-56	5/16	0.96	0.73	0.64	9/16	5/8	0.67
CI-38	3/8	1.01	0.76	0.66	5/8	11/16	0.72
CI-12	1/2	1.15	0.86	0.90	13/16	7/8	0.75
CI-58	5/8	1.18	0.86	0.96	15/16	1	0.78
CI-34	3/4	1.24	0.86	0.96	1-1/16	1-1/8	0.84
CI-01	1	1.51	1.04	1.23	1-3/8	1-1/2	1.03

Matric Range (Dimensions in mm)

PART NO.	T O/D	A LENGTH	C	D	F BODY	G NUT	H BODY
CM-04	4	21.3	16.1	13.70	12	12	14.70
CM-06	6	23.1	17.7	15.30	14	14	15.70
CM-08	8	24.5	18.6	16.20	15	16	17.00
CM-10	10	26.6	19.5	17.20	18	19	19.00
CM-12	12	29.1	22.0	22.00	22	22	19.00
CM-16	16	29.9	22.0	22.00	24	25	19.80
CM-18	18	31.4	22.0	22.00	27	30	21.30
CM-20	20	34.0	22.0	22.00	30	32	23.90
CM-25	25	38.5	26.5	26.50	35	38	26.2

Tube Union Plug

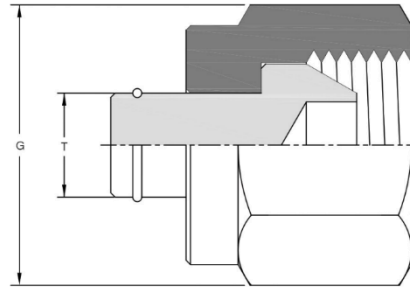

Imperial Range (Dimensions in Inches)

PART NO.	T O/D	G NUT
PI-16	1/16	5/16
PI-18	1/8	7/16
PI-36	3/16	1/2
PI-14	1/4	9/16
PI-56	5/16	5/8
PI-38	3/8	11/16
PI-12	1/2	7/8
PI-58	5/8	1
PI-34	3/4	1-1/8
PI-01	1	1-1/2

Matric Range (Dimensions in mm)

PART NO.	T O/D	G NUT
PM-04	4	12
PM-06	6	14
PM-08	8	17
PM-10	10	19
PM-12	12	22
PM-16	16	27
PM-18	18	30
PM-20	20	30
PM-25	25	41

Tube Nut & Ferrules

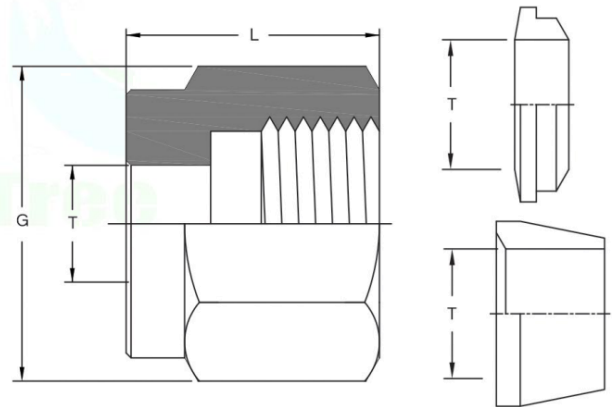

Nut

Imperial Range (Dimensions in Inches)

PART NO.	T O/D	G NUT A/F	L
NI-16	1/16	5/16	0.31
NI-18	1/8	7/16	0.47
NI-36	3/16	1/2	0.50
NI-14	1/4	9/16	0.50
NI-56	5/16	5/8	0.53
NI-38	3/8	11/16	0.56
NI-12	1/2	7/8	0.69
NI-58	5/8	1	0.69
NI-34	3/4	1-1/8	0.69
NI-01	1	1-1/2	0.81

Matric Range (Dimensions in mm)

PART NO.	T O/D	G NUT A/F	L
NM-04	4	12	12.00
NM-06	6	14	12.70
NM-08	8	17	14.00
NM-10	10	17	14.00
NM-12	12	22	17.00
NM-16	16	27	17.46
NM-18	18	30	17.46
NM-20	20	30	17.46
NM-25	25	41	20.64

Ferrules

Imperial Range & Matric Range

PART NO.	T O/D	T O/D
FI-16	1/16	4
FI-18	1/8	6
FI-38	3/8	8
FI-14	1/4	10
FI-56	5/16	12
FI-38	3/8	16
FI-12	1/2	18
FI-58	5/8	20
FI-34	3/4	25
FI-01	1	--

Tube Fittings

